

Product Code: CU4RCD63A

Description: 4 Pole 63A 30mA (Type A) RCCB

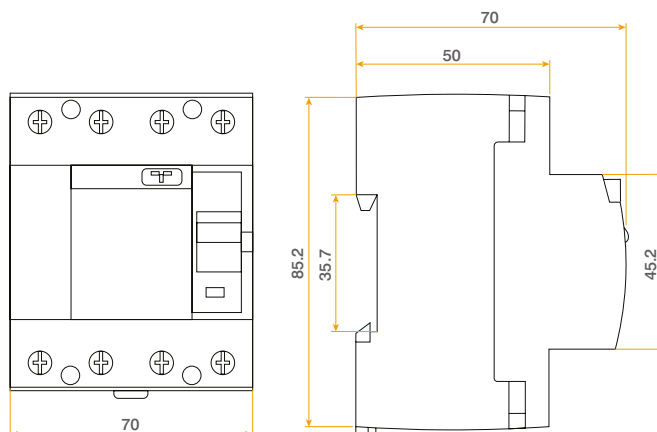

## General Information

Dimensions (mm)	71.2 (W) x 85.2 (H) x 70 (D)
Colour	Light Grey
Rated Operational Voltage (AC) (Ue)	400/415
Frequency (Hz)	50/60
Maximum Rated Current (A) (In)	63
Impulse Withstand Voltage (Uimp)	4000
Type	A
Rated Making & Breaking Capacity (A) (Im)	630
Tripping Current (mA) (in)	30
Residual Non-Operating Current (IΔn)	0.5
Endurance Operations	2000 'ON' & 1000 'OFF' Cycles
Trip Type	Electro-Magnetic Release
Device Terminals	Screwed Lug & Pin
RCD Terminal Capacity (mm²)	35
Number Of Poles	4 (3+N)
Ingress Protection	IP20
Operational Temperature (°C)	-25 to +40
Warranty (Years)	3
RCD Terminal Torque (Nm)	2.5

**Standards** BS EN 61008-1

**Additional Information** For cleaning / polishing of products, use only a soft, dry, clean cloth.

**Compatible Accessories** TPRCDLINK:Three phase RCD Link Kit

